



## General

EcoPac Link 9002 series Smart Wifi fan coil thermostat is widely used in these environment like Homes, Residential buildings, Schools, Hotels, Hospitals, Offices and etc. to main an ideal room temperature purpose.

## Features

- 17 Mainstreaming Languages synchronize in APP(English, Spanish, Russian, Hungarian, Turkey, Hebrew, German, Italian, Japanese, French, Poland, simplified Chinese, traditional Chinese, Holland, Portuguese, Vietnamese, Arabic, Korean)
- Snap-In Easy Installation
- Fit for EU & Standard Junction Electric Box
- Easily Work with Amazon Echo, Google Home, Tmall Genie, IFTTT
- Group Control in 1 App
- Fashion Sense of Science and Technology



## Ordering Guide

|                                |    |                          |      |                             |
|--------------------------------|----|--------------------------|------|-----------------------------|
| ECOPAC LINK 9002               | -2 | 2 pipe(tube) system      | -W   | Window Card input           |
|                                | -4 | 4 pipe(tube) system      | -T   | Clock                       |
| Smart Wifi Fan Coil Thermostat | -M | Modulating output        | -P   | Programmable                |
|                                | -N | Modbus RTU communication | -E   | External Temperature Sensor |
|                                | -K | Key Card occupancy input | -24v | Power Supply with 24Vac     |

e.g. ECOPAC LINK 9002-FC-2KP refers to application: 2 pipe(tube) system, 3 fan speed + 1 H/C valve, with key card and weekly programmable

## Typical Wiring

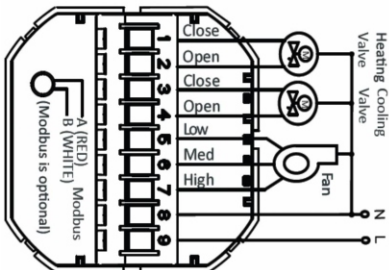

ECOPAC LINK 9002  
--4 pipe(tube) system  
-3-speed fan  
-2 NO/NC valve

## Specification

|                    |  |                      |                             |
|--------------------|--|----------------------|-----------------------------|
| Power Supply       | 24VAC±10%, 50/60Hz   | Sensor               | NTC3950, 10K                |
| Current Load       | Fan Relay 5A(3A-inductive)<br>Valve Relay 3A(1A-inductive) | Temperature Accuracy | ±0.5°C or ±1°F              |
| Storage Temp.      | -5 ~ 45 °C   | Set-Point Range      | 5~35°C                      |
| Power Consumption  | < 1.5W   | Display Temp. Range  | 5 ~ 99°C                    |
| Housing Material   | PC +ABS ( Fireproof)                                       | Timing Error         | < 1%                        |
| Wires on Terminals | Wire 2 x 1.5 mm <sup>2</sup> or 1 x 2.5 mm <sup>2</sup>    | Installation Box     | EU or Standard Electric Box |
| Protection Class   | IP20   | Operating Buttons    | Capacitive Touch Buttons    |

## Installation

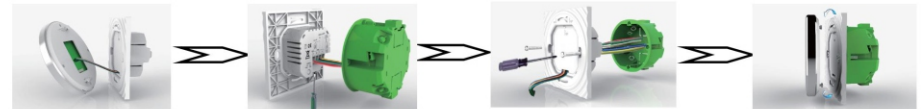

**WARNING: RISK OF ELECTRICAL SHOCK.** Disconnect power supply before making electrical connection. Contact with components carrying hazardous voltage can cause electrical shock and may result in severe personal injury or death.

- Make sure the power is OFF! Try turning ON your heating/cooling system by changing the temperature. If you can't get the system to turn ON in 5 minutes, you'll know the power is OFF.
- Take off the installation faceplate by rotating and gently pulling, then connect voltage supply/load output/external sensor(if with) wires respectively to appropriate terminals.
- Fix the installation plate onto the electric junction box with screws packed in the box.
- Fasten the thermostat display part and the installation faceplate through the groove.(Installation process completed)

## Dimensions and Display

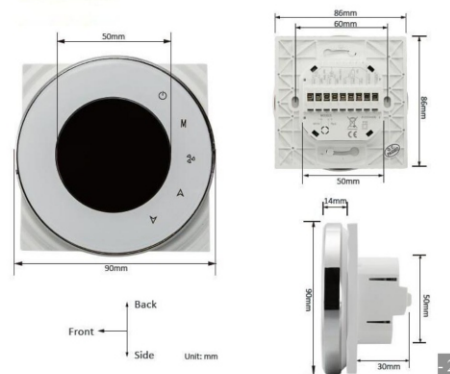

## Operation

| Buttons/Functions                                | Operation  |
|--|--|
|  | Switch thermostat power On or Off  |
| <b>A</b>   | Increase or decrease set-point or parameters   |
|  | Select the Fan Speed in Auto-High-Medium-Low-Auto  |
| Lock/Unlock                                      | Press these 2 buttons <b>A</b> simultaneously and hold for 5 seconds to lock/unlock thermostat.<br><i>Notes: In parameter 3 of ISU process, Full/Half lock configurable.</i>   |
| <b>M</b>   | Switch between Manual and Programmable mode<br>In manual mode, this icon appears in the button left display<br>In programmable mode, the period icon appears in the right side.<br><i>Notes: In programmable mode, the Temperature and Time can not be adjusted</i>  |
| Programmable Schedule Configuration (5+2 weekly) | <p>1.Press <b>M</b> button switch working mode to Programmable mode.</p> <p>2.Set the time and weekday:<br/>Touch <b>M</b> and hold for seconds to set Minute&gt;Hour&gt; Weekday (1 = Monday, 2 = Tuesday etc.)<br/>Increase or decrease parameters by using these icons <b>A</b>  .<br/>Press <b>M</b> once more to confirm and switch to next relevant parameter setting.</p> <p>3. Touch the icon <b>M</b> again to set the weekday schedule [settings appear (1 2 3 4 5) will show along the top of the screen].<br/>Likewise, use <b>A</b>  and <b>M</b> becomingly to adjust the time/temperature for the 1-6 period per day.<br/>Repeat the above process to set the weekend schedule. Press <b>M</b> once more to confirm and exit.</p> |
| <b>Ex-factory Default Settings</b>               |  |
| Time display                                     | WEEKDAY (MON. – FRI.)  |
|  | WEEKEND (SAT. – SUN.)  |
|  | TIME      TEMP.      TIME      TEMP.   |
| Period 1 (Comfort)                               | 06.00 waken      20°C      06.00 waken      20°C   |
| Period 2 (Economy)                               | 08.00 leave      15°C      08.00 leave      20°C   |
| Period 3 (Comfort)                               | 11.30 home      15°C      11.30 home      20°C   |
| Period 4 (Economy)                               | 13.30 leave      15°C      13.30 leave      20°C   |
| Period 5 (Comfort)(1+2)                          | 17.00 home      22°C      17.00 home      15°C   |
| Period 6 (Economy)(3+4)                          | 22.00 bed      15°C      22.00 bed      15°C   |
| External Temp. Display                           | Press and hold the  for 5 sec. to display the temp. of external sensor(if with).   |

*Notes: During the thermostat in wifi connected status, it runs the programmable schedule process made from APP prior to that of thermostat. i.e. The programmable schedule only can be carried out if there is no Wifi connection between thermostat and smartphone/tablet PC.*

## Installer Set-UP Process (ISU)

**⚠** The installation personnel with non-professional training shall not perform this operation!  
During thermostat power off, Press these 2 buttons **M** & simultaneously and hold for 5 seconds to enter ISU process. Press **A** to adjust the configurable parameter value, and press **M** to switch to next parameters. The ISU process will automatically exit and be confirmed after 5 seconds with no operation.

| Parameter | Function                    | Configurable Value  | Default |
|-----------|-----------------------------|---|---------|
| 1         | Temperature calibration     | -7°C to +9°C (internal sensor)  | -1      |
| 2         | Fan Control Type            | 00:When room temp. reaches set point, the fan turns off<br>01:When room temp. reaches set point, the fan turns to low | 00      |
| 3         | Keypad Lock type            | 00: = All buttons will lock except the Power button<br>01: = All buttons will lock                                    | 01      |
| 4         | Heating/Cooling             | 00: Cool only    01:Heating and Cooling   | 01      |
| 5         | Min. set-point limit        | 5°C - 15°C  | 05      |
| 6         | Max. set-point limit        | 15°C - 45°C   | 35      |
| 7         | 12/24 hours format          | 00:12h      01:24h  | 01      |
| 8         | Temperature Display         | 00: display both set-point and room temp.<br>01: display set-point only   | 00      |
| 9         | Economy Mode                | 00: Normal mode<br>01: Energy Saving mode   | 00      |
| A         | Heating Economy Temperature | 10°C - 30°C   | 20      |
| B         | Cooling Economy Temperature | 10°C - 30°C   | 26      |
| C         | Dead Zone                   | 1°C to 5°C (Switching differential)   | 1       |
| D         | Standby Brightness          | 3-99  | 04      |

## Warranty



- Products are warranted for 2 full year (checking and repairing services) from the date of purchase which products are not being damaged by any man-made factors.
- Service outwith the warranty period may incur an extra charge.
- More details please contact with supplier directly.

## Wifi Connection

### Step 1- Download and Install APP

Use your smart phone or tablet PC to Search “Eco Pacific”/”Smart Life” in the app store /Google play to download and install APP .



App Icon

### Step 2- Register your account

- Open “Eco Pacific” application, click “Allow” on the pop up notification dialog(fig 2.1)
- Press “register” button on the register page(fig2.2)
- Select your region and type in your phone No. or email (fig 2.3) then you may get a verification code. Type in your password and confirm (fig 2.4) to complete your registration.
- If you already have an account, please just log in.

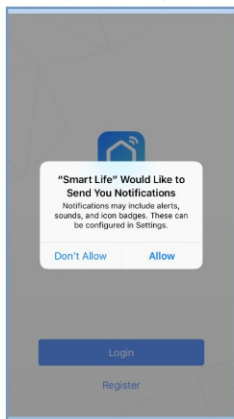

fig 2.1

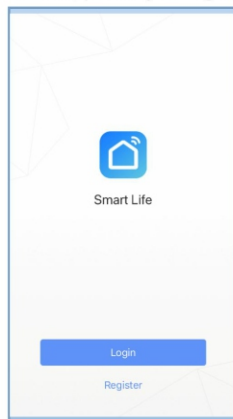

fig 2.2

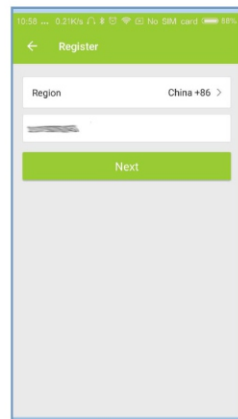

fig 2.3

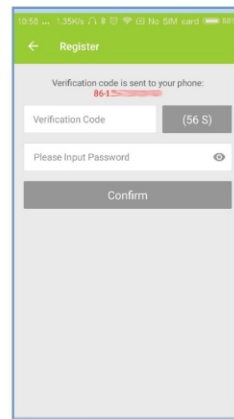

fig 2.4

### Step 3- Connect App with Thermostat

#### On the thermostat

During power off status, press and hold the arrow icon ▼ for 8 sec until the connecting icon appears on the thermostat screen and flashes once a sec.

## On the App

- Press the “+” on the upper right corner of the page (see Fig 3.1) or “Add Device” to add “Thermostat”.
- Click “Confirm indicator rapidly blink” (Fig 3.2) then select your network and back to your App to enter the password of your wireless router(Fig.3.3) and confirm.
- The App will connect with the thermostat successfully. The connecting process takes 5~90 sec, the thermostat name can be editable once connected.(Fig.4.4)

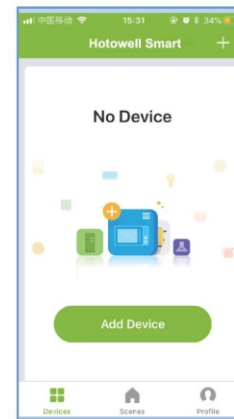

fig 3.1

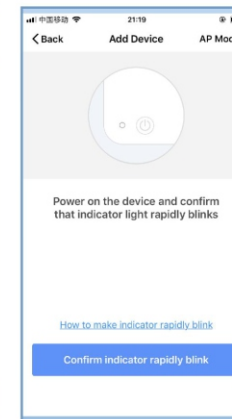

fig 3.2

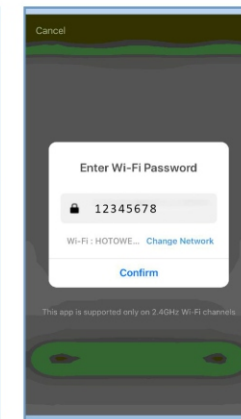

fig 3.3

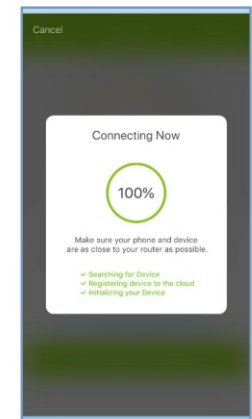

fig 3.4

## Alternative AP mode Connection

\*\*\*If the thermostat has already been connected under above steps, please ignore this process.\*\*\*

This **SMART LIFE** App is only supported on 2.4GHz Wi-Fi channels.

If the router does not be supported, or the wi-fi signal is weak or thermostat can not be connected as above steps, please try this AP mode connection process.

#### On the thermostat

- During power off status, press and hold the arrow icon ▼ for 8 sec until the appears on the thermostat screen and flashes once a sec.
- press and hold the arrow icon ▼ for 8 sec again, the icon will flash once per 3 sec.(fig 4.1)

indicates connecting from normal router mode.

Indicates connecting from AP mode.

#### On the App

- Click “Confirm indicator slowly blink” (fig 4.1) then select your network and back to your app to enter the password of your wireless router (fig 4.2) and confirm. The app will go into the page(fig 4.3)
- Press “Connect now” to select the wifi signal Smart life-XXXX from the thermostat(fig 4.3).
- This AP mode connection process may typically take approx. 5~90 seconds to complete.
- The thermostat name can be edited after connection (fig 4.4).

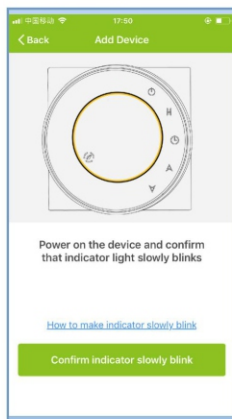

fig 4.1

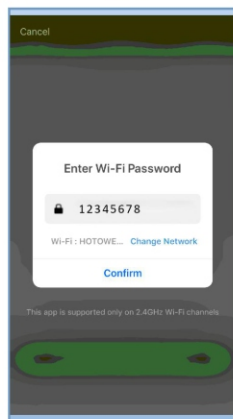

fig 4.2

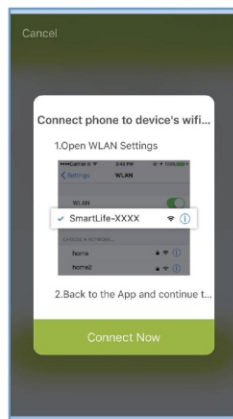

fig 4.3

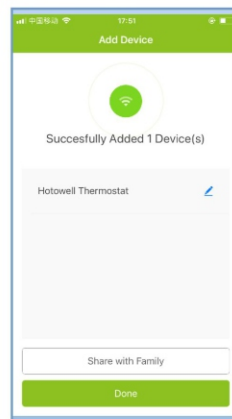

fig 4.4

## Operation Icons on APP

| App Icons | Functions  |
|-----------|--|
|           | Switch thermostat power On or Off  |
|           | Lock/Unlock Icon. Locked=Green, Unlocked=Grey  |
|           | Economy mode. The thermostat runs with the set-point configured as Parameter B in ISU Economy set-point=20°C in default. |
|           | Thermostat runs in Manual Mode   |
|           | Thermostat runs in Programmable Mode   |
|           | System in Cooling Mode   |
|           | System in Heating Mode   |
|           | System in Ventilation Mode   |
|           | Fan Speed Indicator  |

## Programmable Schedule Setting

When thermostat runs in programmable mode, click the “schedule setting” to switch to the schedule page, where you can simply configure the weekly programmable 5+2 schedule up to 6 period each day.

(Workdays=Monday~Friday, Weekend=Saturday and Sunday)

Click “Complete” to save the configuration.

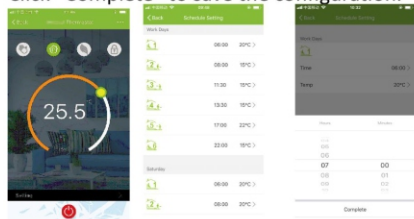

- 7 -

## Group Control and Info. Modify

- Press the menu button as fig 6.1, then click “Create Group”. Select all the rooms you want and confirm.(fig 6.2 and fig 6.3), edit the group name or ungroup as fig 6.3 and fig 6.4
- Group Control allows to control all thermostats(+∞ units) configuration in the group at the same time.



fig 6.1

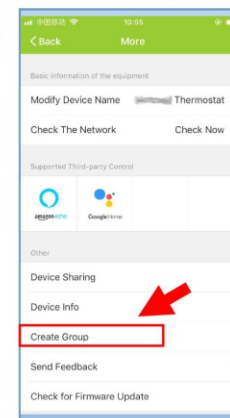

fig 6.2

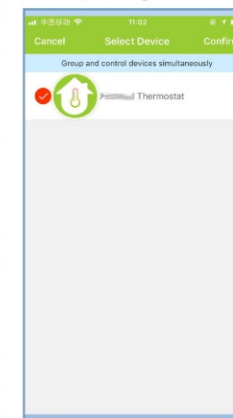

fig 6.3

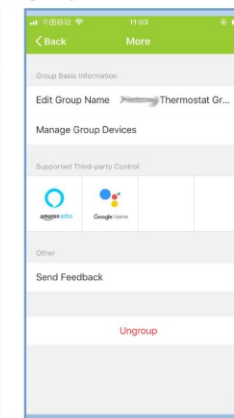

fig 6.4

## Share Thermostat with Others

- Method 1: Click “Share with Family” as fig 4.4.
- Method 2: Click “Profile”>”Sent”>”Add”>Switch on the device>”Share with New Member”>Type in the telephone number you would like to share with.
- Method 3:Home page of the device>Menu(as fig 6.1)>”Device Sharing”>”Add”>>Type in the telephone number you would like to share with.

## Work with 3rd party Echo Control

Click “Profile”>”Integration”>Select amazon echo/Google Home/IFTTT>”Use Now” Details as below fig 7.1 and 7.2.

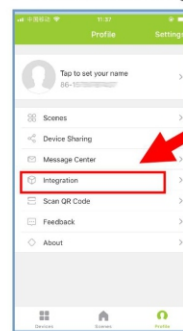

fig 7.1

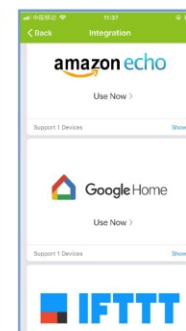

fig 7.2

- 8 -